

MIDDLE PARK 58 Hambleton Street

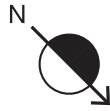

CAYZER

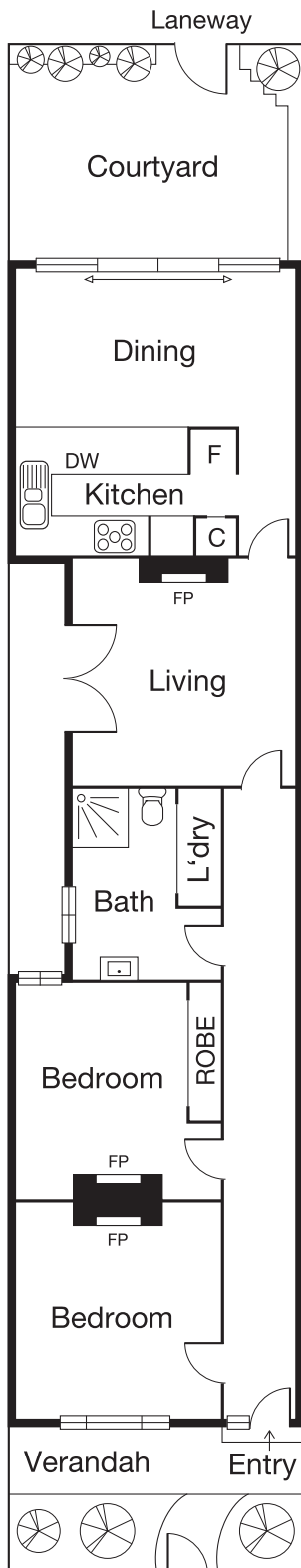

VICTORIAN CHARM, COVETED LOCATION

- Period features throughout: open fire places, Baltic timber floors and high ceilings
- Ducted heating
- AAA location just moments to Albert Park Lake, beach, public transport, schools and Albert Park Village

Perfectly positioned in one of Middle Park's most sought after and quiet tree-lined streets, this well-presented Victorian comprises: Arched hallway entrance, two excellent double bedrooms, large central bathroom including laundry, light and bright living area, fully equipped kitchen with adjacent dining opening to delightful paved courtyard with rear laneway access.

2 1

Auction Saturday 1st December at 1pm

Inspection As advertised or by appointment

Contact Simon Carruthers 0438 811 601
Michael Szulc 0417 122 809
Jason De Stefano 0413 292 666

Mel Ref 57 G5



Interactive Floorplan

CAYZER

Albert Park 330 Montague Street 03 9699 5999
Port Melbourne 370 Bay Street 03 9646 0812

cayzer.com.au